

PowerOne

All-in-one Energy Storage System

Featured practical functions, OTA diagnosis & upgrade and plug & play installation, PowerOne makes on-site installation and maintenance easy and convenient. Its compact design with built-in hybrid inverter occupies less space, and aesthetic appearance fits your smart home in modern life.



Flexible energy storage capacity
5kWh/10kWh/15kWh



Wifi&cloud platform
Remote management & maintenance



Long life LFP Cell
Multiple battery protection



Strong load adaptability
UPS function,10ms on/off grid switchover

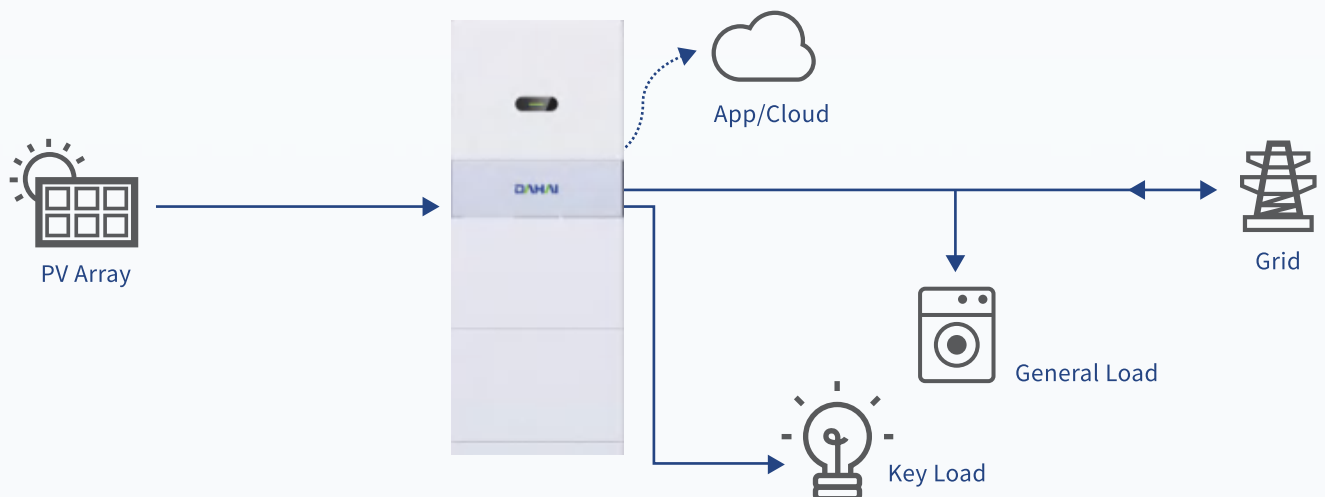

Product Model		PowerOne 3000	PowerOne 4000	PowerOne 5000	PowerOne 6000
HYBRID INVERTER	Off-grid Output				
	Nominal Output Power	3000W	4000W	5000W	6000W
	Nominal Voltage	220V/230V/240V			
	Nominal Frequency	50/60Hz			
	Nominal Output Current	13.6A	18.2A	22.7A	27.2A
	Nominal Output THDu	<2%			
	On-grid Parameter				
	Nominal Output Power	3500W	5000W	6000W	6000W
	Max. Input Current	20A	26.67A	27.5A	27.5A
	Nominal Grid Voltage	220V			
	Max. Output Current	13.6A	22.7A	27.2A	27.2A
	Input Voltage Range	184-264V			
	Nominal Frequency	45-65Hz			
	PV Input				
	Max. Input Power	4500Wp	6000Wp	8000Wp	9000Wp
	Starting Voltage	75V			
	Max. Input Voltage	600V			
	MPPT Operating Voltage Range	80-550V			
	Full Load MPPT Operating Voltage Range	300-500V			
	Number of MPPT	2			
	Nominal Input Voltage	360V			
	Max. Input Current	13A			
	Battery Parameter				
	Battery Type	LFP (LiFePO4)			
	Nominal Battery Voltage	51.2V			
	Battery Voltage Range	42-60V			
	Max. Charge/Discharge Current	75A/75A	85A/85A	100A/100A	100A/100A
Max. Charge/Discharge Power	3750W/3750W	4250W/4250W	5000W/5000W	5000W/5000W	
Efficiency					
Max. Efficiency	97.5%	97.8%	98.0%	98.0%	
European Efficiency	97.2%	97.3%	97.5%	97.5%	
Max. Charging/Discharging Efficiency	94.6%/94.6%				
Protection	PV Insulation Resistance Detection, Residual Current Monitoring, Anti-island Protection, PV Reverse Polarity Protection, AC Over current Protection, AC Short Circuit Protection, AC Over voltage Protection, Surge Protection.				
BATTERY	Module Model	LV5320-S2			
	Battery Type	LFP 16S1P			
	Rated Capacity	5.32kWh			
	Usable Capacity	5.05kWh			
	Nominal Voltage	51.2V			
	Working Voltage	43.2~57.6V			
	Max.Charge/Discharge Current	50A/100A			
	Scalability	Recommended ≤3			
	Weight	45Kg			
	Dimension(W*D*H)	640mm*170mm*400mm			
Cycle Life	>6000 (25°C)				
SYSTEM	Number of module	1	2	3	
	Rated Capacity	5.32kWh	10.64kWh	15.96kWh	
	Max. Battery Charge Power	3750W/4250W/5000W/5000W			
	Max. Battery Discharge Power	3750W/4250W/5000W/5000W			
	Nominal Voltage/Off-grid	220V/230V/240V			
	Operating Temperature	Charge: -10~50°C Discharge: -20~50°C			
	Operating Humidity	0~95% (No Condensation)			
	Storage Temperature	0°C~45°C (Recommended)			
	Storage Humidity	≤85% (RH)			
	Display	LED, App			
	Communication	RS485, CAN, WIFI			
	Cooling Type	Natural cooling			
	Operation Altitude	2000m			
	Ingress Protection Grade	IP65			
	Weight	72Kg	117Kg	162Kg	
	Dimensions(W*D*H)	640mm*170mm*1150mm	640mm*170mm*1550mm	640mm*170mm*1950mm	
Certification & Standard	IEC62109-1:201,IEC62109-2:2011,EN62109-1:2010,IEC62619-2017,EN62109-2:2011,EN61000-6-1, EN61000-6-2,EN61000-6-3,EN61000-6-4,VDE-AR-N 4105 , VDE V 0126- 1- 1, G98/G99, CEI0-21,EN50549,RD 1699,NRS 097-2- 1, AS 4777.2, R25,CE, UN38.3				